

A JOURNEY THROUGH PROVENCE ON THE RHONE



A Camargue horse

TRIP OVERVIEW

Take in France's rural delights, centuries-old monuments and rugged scenery as you cruise along the Rhone and Saone Rivers, journeying from Lyon to Provence. Explore Roman ruins, the wild plains of the Camargue and the winding hidden passageways of Lyon on this captivating eight-day voyage.

ITINERARY & DETAILS

This document aims to give you all the information that you require for a smooth and comfortable river cruise. Please take the time to read this dossier to familiarise yourself with all the aspects of our river cruise. It includes important information such as flight details, visa requirements and travel insurance.

Your included meal guide:

B = Breakfast, L = Lunch, D = Dinner.

DAY 1: UK to Lyon D

Depart London on your scheduled flight to Lyon. Upon arrival, you will be met and transferred to your ship, the MS Camargue. Take a moment to settle into your comfortable cabin and enjoy a welcome cocktail with the crew before dinner.

DAY 2: Lyon to Macon B/L/D

A tour of Lyon begins at the 12th century Fourvière Basilica, which shapes the cityscape with its splendid architecture and towering presence. Soak in incredible panoramas of the city from the esplanade and marvel at the spectacular colours of the mosaics which cover the interior of the chapel. Continue on to Lyon's Old town and discover its unique "traboules", a network of hidden passageways weaving through the city. Spend some free time exploring the historic Saint Jean District, situated in the UNESCO-recognised Old Town and home to the Musée Gadagne and Cathedrale Saint-Jean-Baptiste. At the end of the day, return to your ship and cruise to Macon.

DAY 3: Macon to Vienne B/L/D

After breakfast, travel by coach to the grand Cluny Abbey. Founded in 910, much of the building was dismantled in the 18th century but its past splendour remains with parts of the building providing a blueprint for this monumental structure. In the afternoon, sail down the Rhone towards Vienne, taking in the rolling scenery before an evening of entertainment and dinner on board.

DAY 4: Vienne to Arles B/L/D

Enjoy a walking tour of Vienne and discover why the city is renowned for its art, history and culture. Founded over 2,000 years ago, Vienne boasts outstanding examples of Roman architecture. Your tour begins at the Antique Theatre, considered one of the largest in the Roman Empire. The theatre was resurrected in 1938 and has returned to delighting audiences with artistic events. Continue your walk into the heart of Vienne and visit the exceptionally preserved Temple of Augustus. Complete your tour at the Cathedral of St Maurice before returning to your boat for the journey to Arles.

DAY 5: Arles B/L/D

Following breakfast, journey to the unique natural region of the Camargue. Sit back and enjoy a guided tour past rivers, marshes, and lagoons as you look out for the flamingos, black bulls and the indigenous Camargue horses which inhabit this UNESCO Biosphere Reserve. Later this afternoon, visit a manade (bull breeding farm) to learn about how a manadier works with the animals. End your day with a complimentary cocktail on the farm patio before returning to your vessel in Arles.

DAY 6: Arles to Viviers B/L/D

Depart for Viviers in the morning, stopping at Avignon to explore the impressive monuments scattered throughout the Old town. Wander past the Diocesan Church towards the beating heart of Avignon, Place del'Horloge. This bustling area filled with restaurant terraces is the perfect location to view iconic buildings such as the Town Hall and 19th century theatre. Continue on to the town square at Place du Palace and the Notre Dame des Doms Cathedral before ending your tour at the UNESCO-listed Pope's Palace, where you'll have the opportunity to step inside and explore its grand staterooms and take in magnificent views of the Rhone River. Return to your boat and cruise through the afternoon to Viviers.

DAY 7: Viviers to Lyon B/L/D

After a morning of cruising, arrive at Tournon, situated in the heart of the Rhone Valley. Proceed on foot towards the Chateau Museum, an imposing castle which overlooks the city. Browse through its historic artefacts then walk through the characterful streets and alleys of Tournon's historic centre. To finish the day, delight your senses as you sample a selection of regional food products and wines before returning to your ship in time for tonight's farewell gala dinner.

DAY 8: Lyon to the UK B

Disembark after breakfast for your airport transfer and return flight to the UK.

Meals

Breakfast, lunch and dinner daily are taken on board the ship. Tables seat 4 people, so you'll be able to converse and socialise with new friends, whilst never feeling crowded together. Tea and coffee are available on-board ship as well as unlimited soft drinks and alcoholic drinks, including a variety of wines and beer, both during meals and at the bar. (Premium brands are available at an extra cost). Any dietary requirements and dislikes should be made known to our reservations staff at the time of booking. On embarking the ship, you will be greeted by the captain, crew and staff and treated to welcome cocktails.

SHIP INFORMATION & ROUTE MAP

Ship information - 5★ MS Camargue

Located across the Upper and Main Decks, all 54 cabins are outside-facing with en suite facilities. On-board amenities include a lounge with a dance floor, bar, dining room and large sundeck with deckchairs.

Length: 110m long
Width 10m wide

Capacity: 104 passengers
Cabins: 54

Facilities

■ Lounge-bar with a dance floor ■ Bar - dining room ■ Large sundeck with deckchairs ■ Gift shop ■ Central heating, 220V electricity, air-conditioning, radar, radiophone, Wi-Fi on board.



Cabin with a double bed

Cabin with two single beds

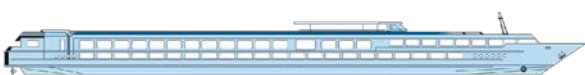
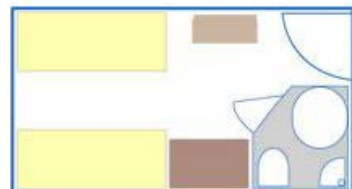
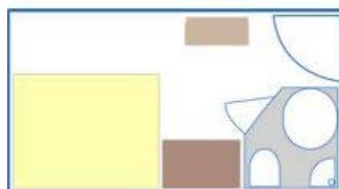

Sun Deck



Upper Deck

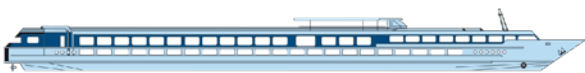

Main Deck

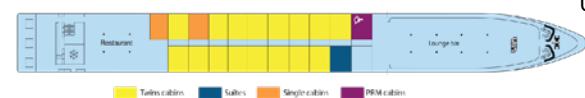

Twins cabins Suites Single cabins P/M cabins

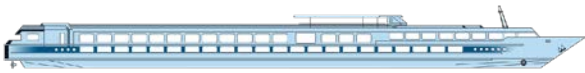

Twins cabins Suites Single cabins

The Cabins

All staterooms are outside with large panoramic windows on the upper deck. Twin beds (converting), generous closets, hair dryer, climate control, private bathroom with shower and bath products, flat screen TV and radio, telephone.

Upper deck: 20 cabins (17 twins, 1 suite, 2 single)

Middle deck: 34 cabins (31 twins, 1 suite, 2 single)

Final confirmation of your deck and cabin will be confirmed at booking.
If the ship detailed is not available, an alternative will be used of a similar standard.

ROUTE MAP



SHIP INFORMATION

Ship information - 4★ MS Rhone Princess

MS Rhone Princess is a grand three-deck ship that has been traveling along the Rhone since 2001. It is a mid-sized vessel with the capacity for 138 passengers.

Length: 110m long
Width 11.40m wide

Capacity: 138 passengers
Cabins: 69

Facilities

- Lounge-bar with a dance floor
- Restaurant
- Large sundeck with deckchairs
- Fitness
- Wi-Fi on board

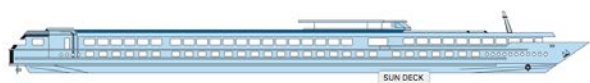

Sun Deck

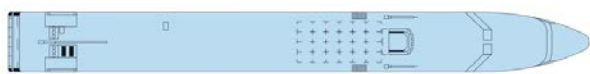

Upper Deck

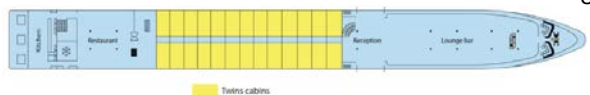
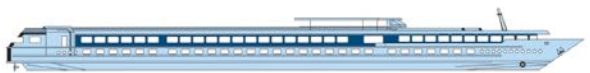

Main Deck

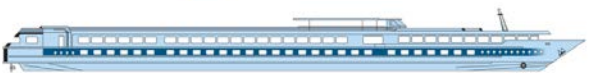

Twins cabins, Suites, Smaller twins cabins

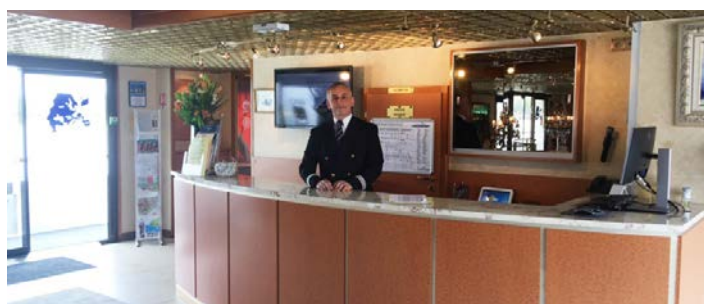

Cabin with a double bed

The Cabins

Cabins are equipped with a TV, private bathroom with shower and toilet, telephone (for internal calls only), towels, safe and independent air-conditioning.

Upper deck: 26 double cabins

Middle deck: 43 cabins (42 double cabins and 1 suite)

Final confirmation of your deck and cabin will be confirmed at booking. If the ship detailed is not available, an alternative will be used of a similar standard.

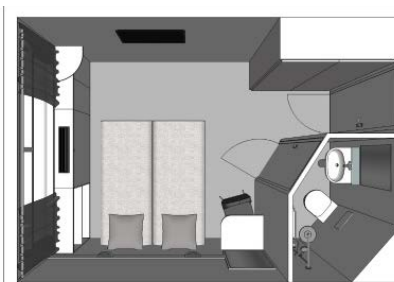

WEATHER AND CLIMATE

Weather can vary quite considerably throughout the year, so please familiarise yourself with the climate charts below.

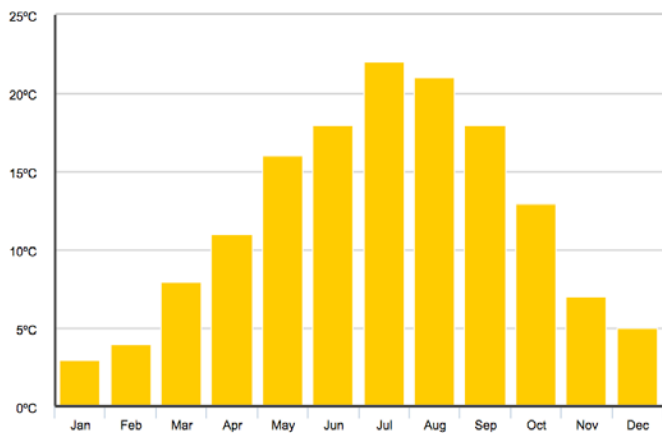

WHAT YOU NEED FOR YOUR TOUR

Visas

A visa is not required for British nationals travelling to France. Further advice should be sought from the applicable tourist authority for other nationalities and for general queries. We strongly advise you check your destinations' Tourist Board or Embassy for the most up-to-date guidelines regarding passport validity.

Tour Guides

Optional excursions are escorted by an experienced, English speaking guide.

Tipping

Tipping is at your discretion. There is an envelope in your cabin for these purpose that can be handed to reception at the end of your cruise

Currency Exchange

The currency in France as well as on board is the Euro (€). We recommend that you exchange your currency before you leave the UK, however cash machines are available in most towns and cities to withdraw money in the local currency.

Personal Expenses

This cruise is All-Inclusive, so you will only need to take a little extra money with you to cover any premium drinks on board and souvenirs, drinks and snacks purchased when off the ship, as well as any optional excursions you wish to book.

Credit Card Information

Credit cards are accepted on board the ship and throughout France.

Itinerary Changes

The Captain and CroisiEurope reserve the right to alter/modify an itinerary at any time, should safety or external circumstances make this necessary, changes are also subject to tides. Some of the highlights may only be seen on optional excursions at an additional cost, or by exploring independently.

Electricity Supply

The electricity supply is 220V. You will need a European two pin round plug adapter in France.

DRESS CODE & WHAT TO PACK

Dress Code

There is no official dress code on board, however you'll be most comfortable during the day in smart casual clothing. You may wish to bring items that do not wrinkle easily as there is no iron provided on board ship. There is an ironing room and a laundry service on board both ships. Bring a variety of clothing for the weather expected on your cruise, including light clothing and bathing suits for hot weather, a jumper or jacket for cooler weather and of course a raincoat and/or small umbrella.

FLIGHT INFORMATION

Your flight is to [Lyon-Saint-Exupéry Airport](#) with [British Airways \(BA\)](#), departing from [London Heathrow Terminal 3](#).

IMPORTANT: Please note that final flight details will be confirmed on your e-ticket and final documentation which will be sent to you approximately 10 days before departure.

Baggage Allowance

Each passenger is entitled to 23kg of hold luggage plus 1 item of hand luggage not exceeding in size and 1 personal item such as a handbag, briefcase or laptop case. Weight restrictions will be finalized on E-ticket receipt. Should you wish to take additional luggage you will need to pay extra at check-in. Check-in should be at least 3 hours before departure.

ON YOUR ARRIVAL

On your arrival in Lyon you will be met by a representative from our local agent, **N&M**, holding a sign displaying: "Mercury Holidays". The Mercury Holidays/N&M representative will show you to your transfer vehicle and escort you to your ship. If you need to contact N&M during your stay the details are:

N&M

Contact number: 0033 4 78 56 56 99

EMBARKING & DISEMBARKING

Embarkation Time: 6pm
Disembarkation Time: 9am

Health and Vaccinations

It is your responsibility to check any health and vaccination requirements applicable to your booked arrangements. We can only provide general information about this. Health and hygiene facilities and disease risks vary from country to country. You should take health advice about your own needs as early as possible and in good time before your departure. Sources of information include; [www.fco.gov.uk](#), [www.travelhealthpro.org.uk](#), [www.hpa.org.uk](#), your General Practitioner or a specialist clinic.

Physical Accessibility

This river cruise is accessible to most people with an average level of fitness and normal mobility. It involves moderate days of walking on cobble streets and getting on and off the cruise ship. This cruise is not suitable for anyone with walking difficulties.

Insurance

We strongly recommend that you and all members of your party are suitably insured as soon as you book your holiday. It is a condition of booking that you must have suitable travel insurance. It is important that you purchase travel insurance that suitably covers your participation in whatever activities you may undertake at the time that you make your booking. To assist you with this, we have arranged travel insurance in partnership with Holiday Extras. To arrange your travel insurance with Holiday Extras, please call **0800 781 4237** and quote '**WK830**' for preferential rates. Please ensure you provide us with the name of your insurer, policy number and their 24 hour emergency contact number as soon as possible. Mercury Holidays will not be liable for any costs incurred by you due to your failure to take out suitable travel insurance from the date of booking.

Passport Information

Your Passport Information is required for this cruise, including place of birth. This information is required at least 70 days prior to your departure. Failure to provide this information on time may result in your booking being cancelled with loss of deposit. This information is required at least 70 days prior to your departure. Failure to provide this information on time may result in your booking being cancelled with loss of deposit.

What to Pack

- Comfortable walking shoes such as trainers for sightseeing excursions
- Sun cream and a hat with a big brim for sunny days
- Sunglasses
- Ruck sack or light bag per person
- Personal toiletries
- Personal toiletries
- Personal first aid kit containing travel pills, rehydration powder, plasters, stomach settlers, antiseptic creams, aspirin etc.

Airport Extras

If you wish to arrange airport car parking, lounges or accommodation at preferential rates, we recommend you book this in advance with Holiday Extra Tel. 0871 360 2000, quoting HX313.

Emergency contact information

Please find below the **CroisiEurope** emergency contact details for the

MS Camargue:

Contact Number: 0033 6 72 97 02 63

MS Rhone Princess:

Contact Number: 0033 73 48 06 21

If your arrival is before this time, you will be transferred to the docking area where you will be able to leave your luggage. You are then free to explore the city at your own pace until it is time to board your ship.

BOARDING DETAILS

Please see below for details of your boarding quay. Your cruise company is **CroisiEurope**. In Lyon, CroisiEurope cruises operate from the below embarkation point: **Quai Claude Bernard, 69007 Lyon, France**



WEATHER AND CLIMATE

Weather can vary quite considerably throughout the year, so please familiarise yourself with the climate charts below.

